

NOV 2015 to present

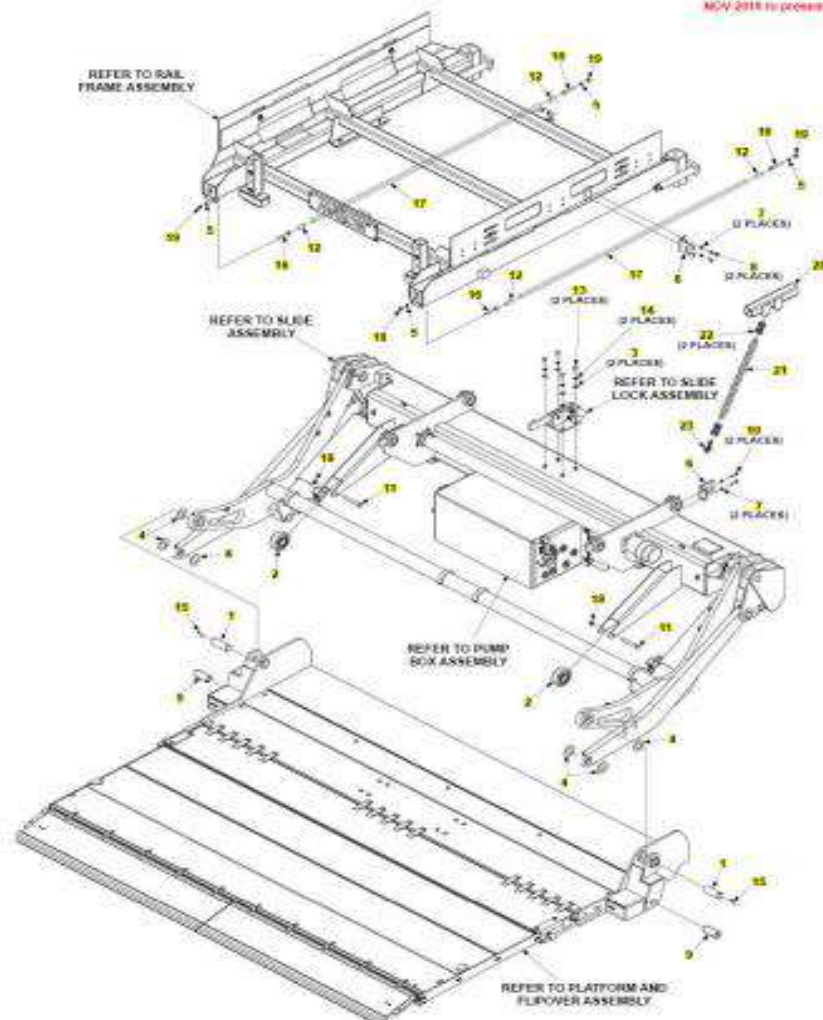

Pos	CPN	Qty	Description
1	RSM0052	2	SL15 DRILLED PIN (2.30" L.O.)
2	280082-01	2	ROLLER, OPENER, 3.5 X 1.25 X .5
3	902001-2	4	WASHER, FLAT 3/8X1/16 ZC
4	908078-02	6	FB THRUST BEARING, 1.25 ID
5	902000-8	4	WASHER, FLAT .312 .083 THK
6	268514-01	2	BRACKET CONDUIT MNT
7	902011-3	4	WASHER, LOCK 5/16X5/64 G8 ZC
8	900009-1	2	SCREW, CAP 5/16-18X5/8 GR8 ZC
9	285217-01	2	SL15 TILT ARM PIN (2.93")
10	900009-6	2	SCREW, CAP 5/16-18X1-1/4 G8 ZC
11	900033-10	2	SCREW, CAP 5-20X3.5 GR8 ZC
12	268263-01	4	LINK, CONNECTING ANS#50
13	900014-4	4	SCREW, HEX CAP 3/8-16X1, G8 ZC
14	902011-4	4	WASHER, LOCK 3/8X.094 ZC
15	905033-5	2	ROLL PIN .250 O.D X2.00" LG
16	RSM0017	4	SL15 CHAIN ADJUSTER
17	268262-12	2	CHAIN, CRES. ANS#50, 83 LINKS
18	901008	2	NUT, NYLON 1/2-20 ZC
19	901001	4	NUT, NYLON 5/16-18 ZINC
20	287133-01	1	MNTG LATCH GAINH WELDMENT
21	282886-07	1	CHAIN GALV. .38X18.10 LG
22	285089-01	2	CHAIN SHACKLE
23	225090	1	HOOK, SNAP 3/4X4 750# ZINC